

**LIGHTING FOR COMPLEX ENVIRONMENTS**

**4 ft. long**

**APPLICATIONS**

- Cleanrooms
- Electronics labs
- Hospitals
- Pharmaceutical labs
- Biological labs

Aerodynamically shaped housings, which will not cause turbulence in laminar flow rooms, smooth outside surface, and row mounting make CLT Series ideally suited for CLEANROOM, Hospital, and Scientific lab areas, where contamination free environment is a must.

**FEATURES**

- ♦ Aerodynamically shaped 20 gauge steel sealed Housing ideally suited for Laminar flow rooms
- ♦ Works with 1", 1 1/2" and 2" inverted "T" ceiling grid
- ♦ 4 ft. fixture length matches nominal grid length
- ♦ Can be mounted in continuous rows
- ♦ Gasketed Lens with internal prisms and smooth outer surface
- ♦ No exterior hardware
- ♦ Manufactured in accordance to NSF, FDA, USDA and Federal Standard 209D
- ♦ Suitable for Class 10 - Class 100,000 Cleanrooms

**CROSS SECTION**

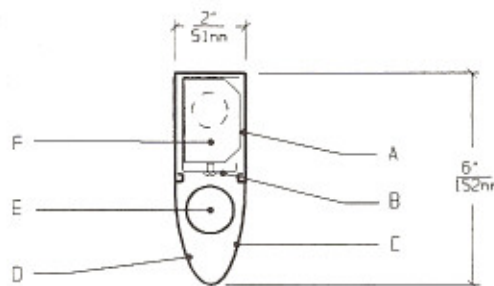

**TOP VIEW**

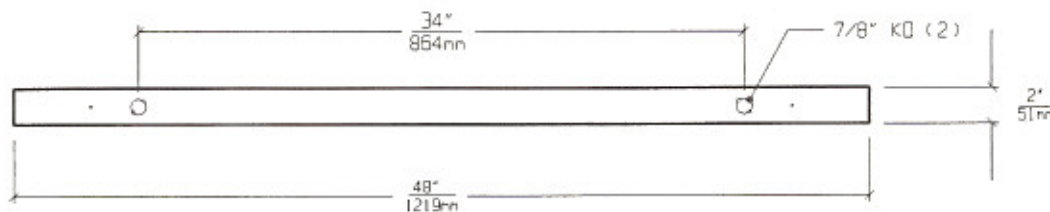

**SPECIFICATIONS**

|   |   |
|---|---|
| <p><b>A. HOUSING</b> Die formed 20 gauge cold rolled steel Housing, with welded seams and End Caps.</p> <p><b>B. REFLECTOR</b> Die formed one piece 18 gauge cold rolled steel. Painted white.</p> <p><b>C. GASKET</b> Closed cell gaskets prevent air and contaminants from entering the room.</p> <p><b>D. LENS</b> Low brightness Lens with prisms up and smooth side to room for ease of cleaning. (See Options).</p> | <p><b>E. LAMPS</b> 32W T-8, 40W T-12 or 40W Biax Lamps. See Lamp Options. (Lamps by others).</p> <p><b>F. BALLAST</b> HPF, Class P, Energy saving Ballast (See Voltage, Ballast Options).</p> <p><b>G. FINISH</b> Polyester Powder coat white finish with 92% reflectance.</p> <p><b>H. UL LISTED</b> Suitable for Wet Locations.</p> |
|---|---|

**LAMP SELECTION**



LAMPS: (1) 32W T-8  
(1) 40W T-12



LAMPS: (2) 40W BIAx

**ORDERING INFORMATION**

**CLT - 4 -**

| WATTAGE                            | VOLTAGE                        | BALLAST                     | LENS                            | OPTIONS  |
|------------------------------------|--------------------------------|-----------------------------|---------------------------------|--|
| 32=32 Watts<br>(T-8)               | 120=120 Volts<br>277=277 Volts | EB=Electronic<br>Ballast    | CL=Clear Lens,<br>Prismatic     | EM=Emergency Lighting<br>GF=GLR Fuse   |
| 40=40 Watts<br>(T-12)              | 347=347 Volts                  | MB=Magnetic<br>Ballast      | OL=Opal Lens<br>UV=Ultra Violet | AHP=Aluminum Housing, Painted<br>DB=Dimming Ballast  |
| 40BX=(2) 40Watts<br>Biax Twin Tube |                                | EBH=<10% THD<br>El. Ballast | Yellow Lens                     | CW=Cold Weather<br>Ballast<br>SHP=Stainless Steel<br>Housing, Painted<br>RF=Radio Frequency<br>Interference Filter |

(More than one Option  
can be specified)

**EXAMPLE: CLT - 4 - 32 - 277 - EB - CL - GF - SHP**

**DESCRIPTION:** CLT - 4 = Series CLT, 4 feet nominal length  
 32 = (1) 32 Watts T-8 Lamp  
 277 = 277 Volt Operation  
 EB = Electronic Ballast  
 CL = Clear Prismatic Lens  
 GF = GLR Fuse  
 SHP = Stainless Steel Housing, Painted

| FIXTURE TYPE   |        | COMMENTS |
|----------------|--------|----------|
| CATALOG NUMBER | CLT-4- |          |
| JOB NAME       |        |          |
| APPROVAL       |        |          |
| DATE           |        |          |
|                |        |          |

Dimensions and Specifications subject to change without notice  
 Fixture guaranteed for one year against mechanical defects in manufacture.  
 2-97 CLT-4