

LIGHTING FOR COMPLEX ENVIRONMENTS

APPLICATIONS

- Detention Cell Lighting
- Prison Day Rooms and Common Areas
- Psychiatric Ward Lighting
- Rehabilitation Centers
- Transit Platforms

Heavy gauge housings with concealed hinges, unbreakable lenses, tamperproof screws and absence of cracks and crevices make DSH Series ideally suited for DETENTION and SECURITY areas, where physical attack or abuse are expected.

FEATURES

- Heavy gauge Housing and Lens Frame
- 20" x 20" nominal Housing size
- One piece Lens Frame with tightly closed corners
- Exterior / Interior Lens system provides protection and uniform illumination
- Tamperproof Screws with captive cage nuts
- Concealed Hinge to optimize security
- Removable Reflector
- Lens secured to Lens Frame by through studs and heavy gauge steel rails
- Maximum, Medium, Minimum or Super Max. security

CROSS SECTION

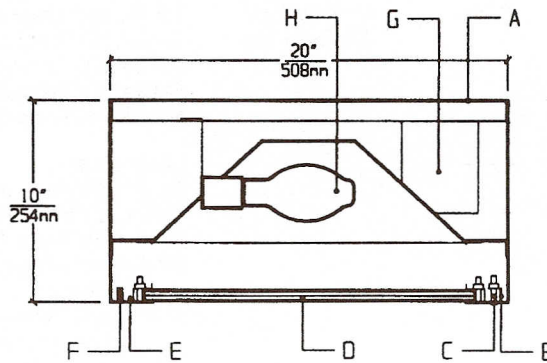

LENS FRAME DIMENSIONS

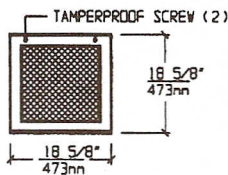

TOP VIEW

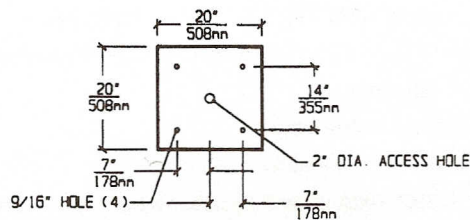

SPECIFICATIONS

A. HOUSING	Die formed cold rolled steel Housing, with welded seams. Specify gauge. (See Options).	F. HINGE	Heavy gauge concealed continuous piano hinge with welded pin ends.
B. GASKET	Polyurethane Gasket around inside of Lens Frame to prevent light leaks.	G. BALLAST	ETL / CBM certified, HPF ballast, securely mounted to ensure low operating temperature and long life..
C. FASTENERS	Captive tamperproof fasteners. (Torx head standard. For others see Options).	H. LAMPS	Metal Halide, High Pressure Sodium, Mercury Vapor. See Lamp Options. (Lamps by others).
D. LENS	Per spec. Specify Lenses for Room / Lamp sides. (See Lens option).	I. FINISH	Polyester Powder coat white finish with 92% reflectance.
E. LENS FRAME	Die formed one piece cold rolled steel Lens Frame in heavy gauge to match Housing.	J. UL LISTED	Suitable for Wet Locations.

LAMP SELECTION

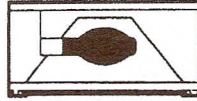

LAMPS: (1) up to 250W HPS, Metal Halide or Mercury Vapor

ORDERING INFORMATION

DSH-20					
GAUGE	WATTAGE	LAMP TYPE	VOLTAGE	LENS OPTION	OPTIONS
T=12 Gauge Super Max.	70=70 W 100=100 W	M=Metal Halide S=High Pressure Sodium	120=120 Volts 208=208 Volts 240=240 Volts	ROOM SIDE 18CP=.187"Clear P/C 25CP=.250"Clear P/C 37CP=.375"Clear P/C 50CP=.500" Clear P/C	AH=Allen Head Screws GF=GLR Fuse QS=Quartz Socket (DCB) QR=Quartz Restrike Sys.
F=14 Gauge Maximum	150=150 W 175=175 W	MV=Mercury Vapor	277=277 Volts	18TG=.187"Temp.Glass 25TG=.250"Temp.Glass 37TG=.375"Temp.Glass 50TG=.500"Temp.Glass	(More than one Option can be specified)
S=16 Gauge Medium	250=250 W		DT=Dual Tap QT=Quad Tap		
E=18 Gauge Minimum					
				LAMP SIDE 15PP=.156"Prism P/C 18PP=.187"Prism P/C 15PG=.156"Prism.Temp.Glass DP=Dropped Polycarbonate Refractor (Other Lens Options Available. Consult Factory)	

EXAMPLE: DSH - 20 - F - 150 - M - 277 - 25CP/15PG - AH

DESCRIPTION: DSH - 20 = Series DSH, 20 X 20 inches nominal size
 F = 14 Gauge Cold Rolled Steel - Maximum Security
 150 = 150 Watts
 M = Metal Halide lamp
 277 = 277 Volt Operation
 25CP/15PG = .250" Thick Clear Polycarbonate on Room Side / .156" Thick Prismatic Tempered Glass on Lamp Side
 AH = Allen Head Screws in Lens Frame

FIXTURE TYPE		COMMENTS
CATALOG NUMBER	DSH-20-	
JOB NAME		
APPROVAL		
DATE		

Dimensions and Specifications subject to change without notice
 Fixture guaranteed for one year against mechanical defects in manufacture.
 Copyright 2-99 DSH-20