

**LIGHTING FOR COMPLEX ENVIRONMENTS 1 lamp, 4 ft. long**

**APPLICATIONS**

- Schools / Universities
- Apartments / Condominiums / Public Housing
- Convenience Stores
- Government Facilities
- Hospitals

Heavy gauge backpans with molded unbreakable lenses and tamperproof screws help VSL Series withstand severe punishment, and make them ideally suited for VANDAL and HIGH ABUSE areas, where deliberate tampering is expected.

**FEATURES**

- ♦ 16 gauge die formed Backpan
- ♦ 4 feet by 5 in. nominal size
- ♦ Injection molded prismatic polycarbonate Refractor provides uniform illumination
- ♦ Tamperproof Screws with captive cage nuts
- ♦ Ceiling or Wall mounted
- ♦ Non-corrosive durable coating
- ♦ Maintenance free, one time installation
- ♦ Stands up to physical impact and tampering
- ♦ Removable Power Tray

**CROSS SECTION**

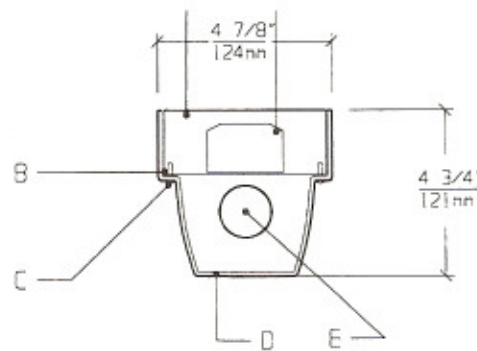

**LENS FRAME DIMENSIONS**

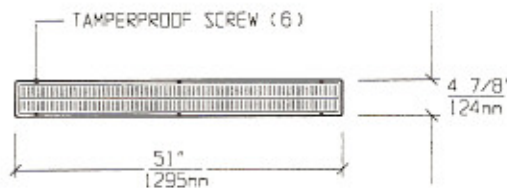

**TOP VIEW / MOUNTING DIMENSIONS**

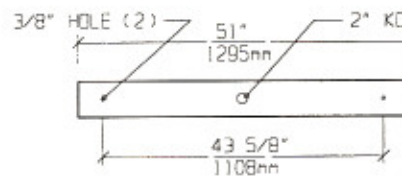

**SPECIFICATIONS**

<p><b>A. BACKPAN</b> 16 gauge die formed cold rolled steel Backpan with welded seams.</p>	<p><b>E. LAMPS</b> 32W T-8 or 40W T-12 Lamps. See Lamp Options. (Lamps by others).</p>
<p><b>B. GASKET</b> Polyurethane Gasket around inside of Lens to prevent light leaks.</p>	<p><b>F. BALLAST</b> HPF, Class P, Energy saving Ballast (See Voltage, Ballast Options).</p>
<p><b>C. FASTENERS</b> Captive tamperproof fasteners. (Torx head standard. For others see Options).</p>	<p><b>G. FINISH</b> Polyester Powder coat white finish with 92% reflectance</p>
<p><b>D. LENS</b> .187" prismatic polycarbonate Lens with external prisms for even illumination. Injection molded.</p>	<p><b>H. U.L. LISTED</b> Suitable for Damp Locations. Wet Locations construction available.</p>

LAMP SELECTION



LAMPS: (1) 32W T-8  
(1) 40W T-12

ORDERING INFORMATION

VSL - 14 - 1 -				
No. of LAMPS	WATTAGE	VOLTAGE	BALLAST	OPTIONS
1=1 Lamp	32=32 Watts (T-8)	120=120 Volts 277=277 Volts	EB=Electronic Ballast	OL=Opal Lens GF=GLR Fuse
	40=40 Watts (T-12)	347=347 Volts	MB=Magnetic Ballast EBH=<10% THD El. Ballast	NL=Night Light (PL-7 or 9) DB=Dimming Ballast EM=Emergency Lighting CW=Cold Weather Ballast RF=Radio Frequency Interference Filter AH=Allen Head Screws OH=Oval Head Screws

(More than one Option  
can be specified)

EXAMPLE: VSL - 14 - 1 - 32 - 277 - EB - GF - NL

DESCRIPTION: VSL-14 = Series VSL, 1 lamp, 4 feet long  
 1 = 1 Lamp  
 32 = 32 Watts T-8 Lamp  
 277 = 277 Volt Operation  
 EB = Electronic Ballast  
 GF = GLR Fuse  
 NL = Night Light for PL - 7 or 9

FIXTURE TYPE		COMMENTS
CATALOG NUMBER	VSL-14-	
JOB NAME		
APPROVAL		
DATE		

Dimensions and Specifications subject to change without notice  
 Fixture guaranteed for one year against mechanical defects in manufacture.  
 2-97 VSL-14